

92-K-61 - SPEEDLINE System Data Sheet - Version V1 (24-10-23)

SPEEDLINE 92mm 'C' Stud Partition @600mm Ctrs,
with 2x Knauf 12.5mm Fire Panel each side

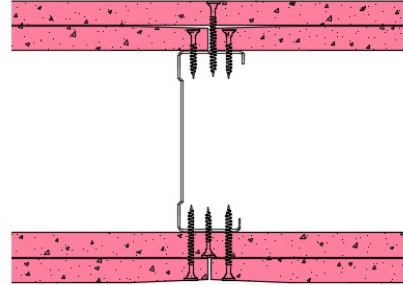

System Performance Breakdown

Fire Resistance:

BS476 Part 22:1987:

Test Ref & Date or Applied Ref & Report:

Max Height:

Thickness:

Duty Grade: BS 5234: Part 2:1992:

Sound Insulation:

120/120 Minutes (Integrity/Insulation).

BRE-P100456-1084 - BRE Report P102396-1011B

Refer to Speedline Specification Clause

142 mm. (At Base Track, Excluding Finishes)

Severe - Annexes A-F

46 R_w dB, Date Tested or Assessed Against - 70-K-57

p

Test Code:
H17517AA
Test Date:
08/08/2011

Freq. Hz	R dB
50	20.8
63	15.3
80	10.7
100	19.6
125	22.5
160	31.4
200	35.4
250	36.9
315	39.1
400	43.1
500	47.7
630	49.4
800	54.1
1000	55.5
1250	57.5
1600	60.6
2000	60.7
2500	51.0
3150	46.6
4000	49.4
5000	53.1
6300	
8000	
10000	

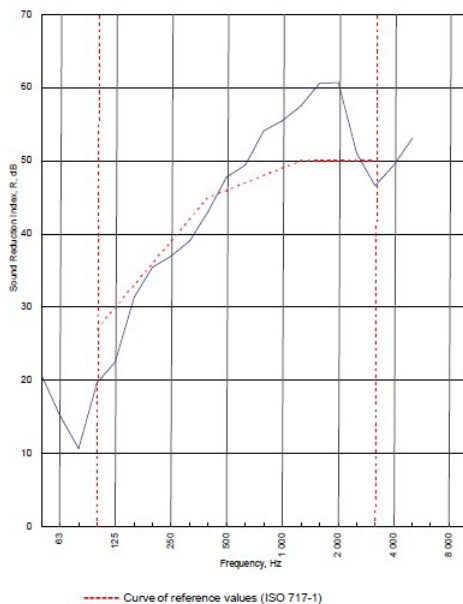

Rating according to BS EN ISO 717-1:1997
 R_w (C;Ctr) = 46 (-3;-9) dB
Max dev. 7.5 dB at 125 Hz

Evaluation based on laboratory measurement results obtained by an engineering method:

$C_{50-3150}$ = -6 dB	$C_{50-5000}$ = -5 dB	$C_{100-5000}$ = -2 dB
$C_{0,50-3150}$ = -16 dB	$C_{0,50-5000}$ = -16 dB	$C_{0,100-5000}$ = -9 dB

TESTED AT ONE OF THE UKAS ACCREDITED LABORATORIES BELOW

B.T.C
(H-Ref on Graph)

B.R.E

AIRO

S.R.L

Customer: Metsec plc Hepsec Division

BTC 17517A: Page 8 of 10



SPEEDLINE Drywall Systems, Adsetts House, 16 Europa View, Sheffield Business Park, Sheffield, S9 1XH.

Tel: 0114 231 8030.

Email: enquiries@speedlinedrywall.co.uk

(As per the requirements set out in ISO/IEC 17025:2017 regarding test data the results stated have been carried out by voestalpine Metsec plc as part of the contract to supply Speedline Metal Sections to SIG Plc)